

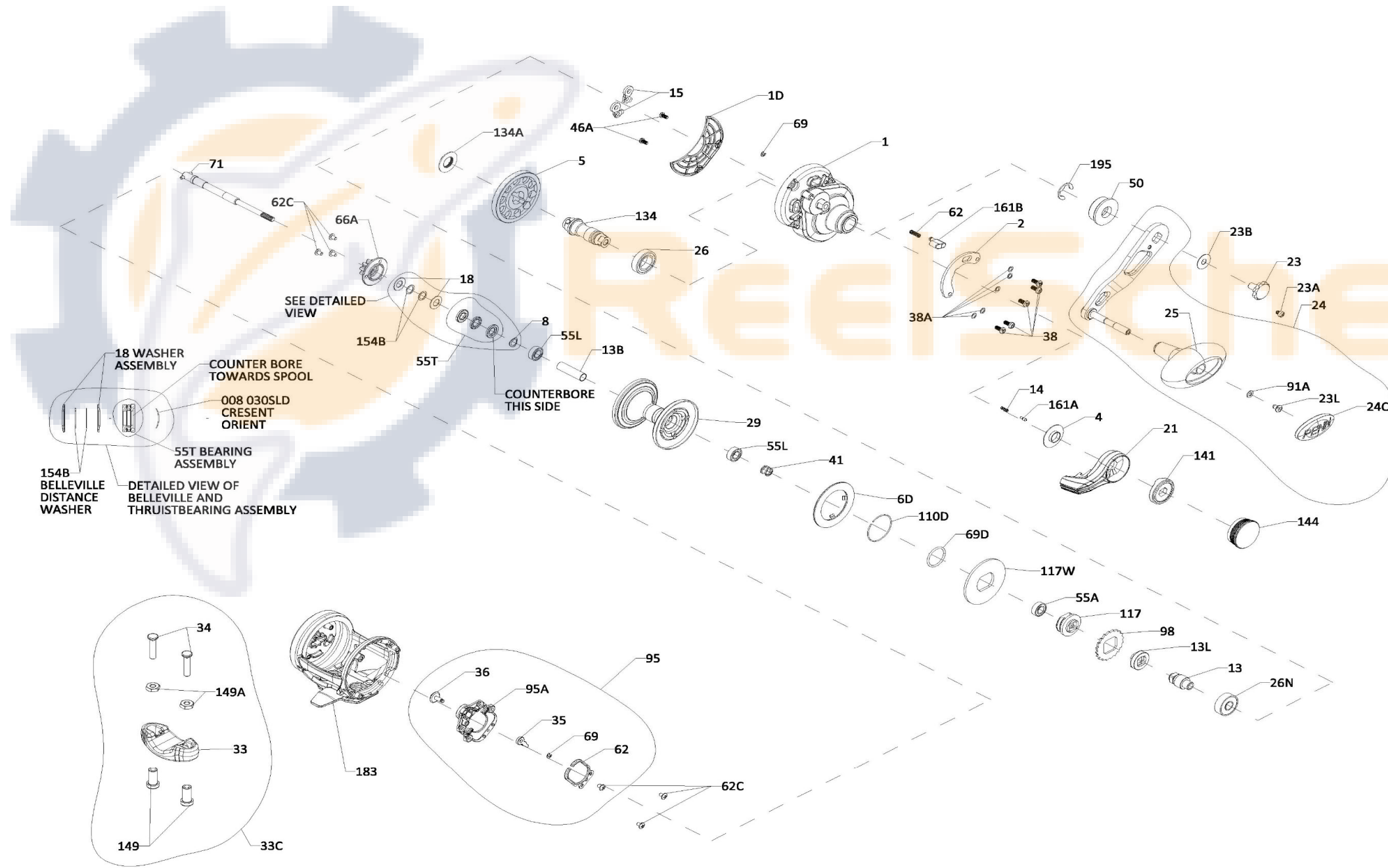

PARTS LIST FOR MODEL
Fathom II 10XNLD, 15LD
REEL PART NO. 1563376, 1563377



Key No.	Part No.	Penn Style No.	Description	Parts List
1	1580132	1-FTHII10XNLD	Right Side Plate (10XN)	
1	1580133	1-FTHII15LD	Right Side Plate (15)	
1D	1580169	1D-FTHII15LD2	Gearbox Cover	
2	1580173	2-FTHII15LD2	Quadrant	
4	1264978	4-TRQ15LD2	Lever Washer	
5	1338138	5-FTH15LD	Main Gear	
8	1257843	8-30SLD	Spring Washer	
13	1338142	13-FTH15LD	Pinion	
13B	1580185	13B-FTHII10XNLD2	Spacer Tube (10XN)	
13B	1580186	13B-FTHII15LD2	Spacer Tube (15)	
13L	1338146	13L-FTH40NLD	Spacer	
14	1181406	14-535	Spring	
15	1229374	15-TRQ40	Dog Asm (2 req)	
18	1265001	18-TRQ40NLD2	Spring Washer (2 req)	
21	1580195	21-FTHII15LD2	Drag Lever	
23	1208117	21-FTH20LW	Handle Screw	
23A	1188717	23A-20	Handle Lock Screw	
23B	1207784	23B-20	Handle Screw Washer	
23L	1191383	23L-750	Screw	
24	1580204	24-FTHII25NLD	Handle Assembly	
24C	1191335	24C-66	Cap- Handle Knob	
25	1240293	25-TRQ40	Handle Knob	
26	1265023	26-TRQ40NLD2	Bearing	
26N	1182145	26N-25	Bearing	
29	1580209	29-FTHII10XNLD2	Spool (10XN)	
29	1580210	29-FTHII15LD2	Spool (15)	
33	1290729	33-TRQ	Rod Clamp (15)	
33C	1580218	33C-FTHIILD2	Rod Clamp Kit (15)	
34	1580220	34-FTHIILD2	Screw, Rod Clamp (15) (2 req)	
35	1188656	35-20	Click Tongue	
36	1516151	36-FTHII15SD	Click Button	
38	1309885	38-FTH15LD	Screw (5 req)	
38A	1188649	38A-20	Flat Washer (5 req)	
41	1309886	41-FTH15LD2	Drag Disengaging Spring	
46A	1488755	46A-FTHII30LW	Cover Plate Screw (2 req)	
50	1309888	50-FTH30LD2	Shield Guard	
55A	1238912	55A-50SLD	Ball Bearing	
55T	1238913	55T-30SLD	Thrust Bearing	
62	1188664	62-20	Click Spring	
62A	1236596	62-TRQ40	Spring Click Locator	
62C	1188654	62C-20	Screw (7 req)	
66A	1265059	66A-FTHLD	Click Gear	
69	1188657	69-20	Retainer (2 req)	
69D	1265060	69D-FTH15LD	Retaining Ring	
71	1580229	71-FTHII10XNLD2	Spindle (10XN)	
71	1580230	71-FTHII15LD2	Spindle (15)	
91A	1277514	91A-TRQ40NLD2	Handle Knob Washer	
95	1580237	95-FTHIILD2	Click Module Assembly	
95A	1580238	95A-FTHIILD2	Click Module Housing	
98	1265072	98-FTH15LD2	Ratchet	
110D	1309895	110D-FTH15LD2	Retaining Ring	
117	1309896	117-FTH15LD2	Drive Plate	
117A	1309897	117A-FTH15LD2	Drag Washer (Assembly)	
117W	1309900	117W-FTH15LD2	Drag Washer Metal	
134	1338160	134-FTH40NLD	Gear Stud	
134A	1265086	134A-30SLD2	Nut Gear Stud	
141	1580246	141-FTHIILD	Cam Follower	
144A	1580247	144-FTHIILD	Preset Knob Assembly	
149	1184702	149-45	Rod Clamp Nut (15) (2 req)	
149A	1184706	149-200	Hex Nut (15) (2 req)	
154B	1309904	154B-FTH40NLD2	Belleville Distance Washer (2 req)	
161A	1265098	161A-TRQ15LD2	Lever Click Pin	
161B	1265099	161B-TRQ40NLD2	Strike Button	
195	1184955	195-40	Retaining Ring	